

LED light signal insert

Operating instructions

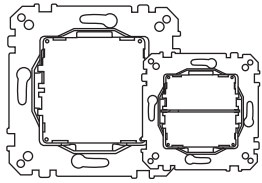

LED light signal insert, single-colour
Art. no. MTN587090/91/93/94

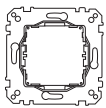

LED light signal insert, two-colour
Art. no. MTN587092

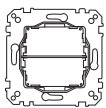

Getting to know the LED light signal insert

The LED light signal insert serves as an illuminated display unit. The monochrome version has the option of either a green LED (MTN587090), a red LED (MTN587091), a white LED (MTN587093) or a blue LED lighting (MTN587094). The two-coloured version has a red/green LED lighting (MTN587092). To separate the lit area on the two-coloured version, a separating web (A) is placed onto the insert.

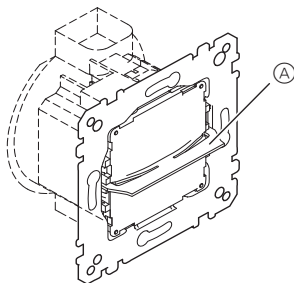

The accompanying central plate with window must be ordered separately. The various preprinted films are included with the insert. If required, you can create films with individual lettering at any time. The central plate with window is clipped onto the LED light signal insert. You can switch the LED light signal insert on and off via the following inserts:

- **LED light signal insert MTN587092, two-coloured:** Shutter rocker switch insert with mechanical reverse voltage protection MTN311501.

For this application, the rocker for two-circuit switch (MTN4356.. and MTN4326..) is available with the imprint "bell crossed through" and "chambermaid".

If both illuminated areas should light up at the same time, use the series switch insert MTN311500 instead of the shutter rocker switch insert MTN311501. The series switch insert is connected in the same way but has no reverse voltage protection..

- **LED light signal insert MTN587090/91/93/94, monochrome:** Two-way switch insert MTN311600.

How to connect the LED light signal insert

Connect the LED light signal insert according to the illustrated circuit diagrams.

Connection to the shutter rocker switch insert with mechanical reverse voltage protection MTN311501:

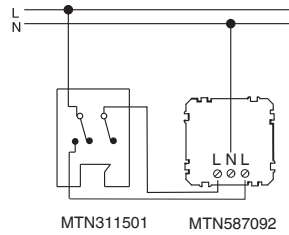

CAUTION
The LED light signal insert may be damaged if two different phases are connected. Only connect the same phase to the L connection terminals.

Connection to the two-way switch insert MTN311600:

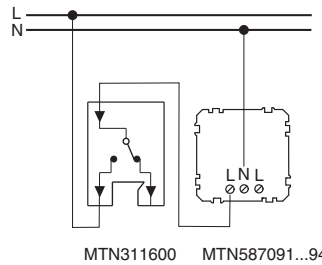

CAUTION
Power transmission via the two L connection terminals can destroy the device. Only ever connect one L connection terminal. Do not use the L connection terminals for through-wiring.

How to install the LED light signal insert

You can install the LED light signal insert in any size 60 installation box (flush-mounted box, hollow wall box, cable duct box..).

The two-coloured version with separating web is pictured:

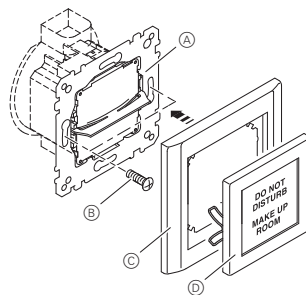

- (A) LED light signal insert onto the flush-mounted socket
- (B) Screws
- (C) Frame
- (D) Central plate with window

- ① Using the screws provided, screw the supporting ring of the LED light signal insert onto the flush-mounted socket.
- ② Clip the central plate with window onto the supporting ring, together with the frame.

How to insert the desired film into the central plate with window

The central plate with window is supplied with a retaining film already inserted. This retaining film serves the purpose of securing the symbol film in the central plate with window.

This is how you insert the film with the desired print:

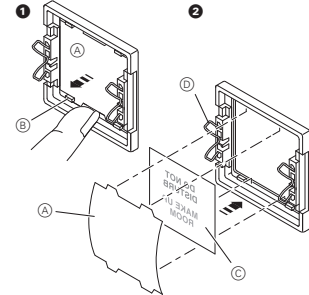

- (A) Retaining film
- (B) Lug
- (C) Symbol film
- (D) Spring

- ① Remove retaining film. To do this, insert your fingernail underneath the lug and peel off the retaining film.
- ② Insert symbol film towards the front in the central plate with window. While doing this, springs of the central plate must be to the left and right of the printed motif.
- ③ Insert retaining film into the central plate with window again. To do this, push the retaining film under the lugs.

How to create individual films

Using the labeling software MTN615022, you can easily create individual films for the LED light signal insert. If you already own a version of the lettering software, you can download the update for the LED light signal insert at www.schneider-electric.com.

Alternatively, you can create your own template according to the dimensioned sketch pictured below.

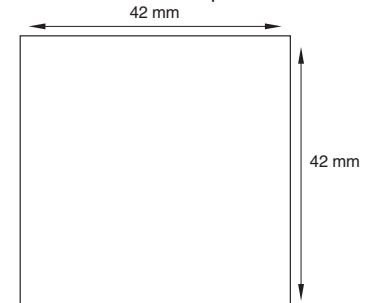

Please consult the operating manual for your printer to find out which films you can use.

How to clean the central plate with window

Wipe the central plate with window with a moderately damp cloth and, if necessary, rub dry with a lint-free cloth.

CAUTION
Do not use harsh cleaning agents or those which contain solvents to clean the central plate with window. Do not spray cleaning agents directly onto the central plate, as excess cleaning agent could get underneath the central plate.

Technical data

Supply voltage:	120 V - 230 V / 60 Hz 150 V - 230 V / 50 Hz
Protection level	IP 20
Dimensions LED light signal insert (W x H x D):	50,2 x 46,5 x 32 mm (without separating web and supporting ring)
Dimensions of central plate (WxH):	55,5 x 55,5 mm

Schneider Electric Industries SAS

If you have technical questions, please contact the Customer Care Center in your country.

www.schneider-electric.com

This product must be installed, connected and used in compliance with prevailing standards and/or installation regulations. As standards, specifications and designs develop from time to time, always ask for confirmation of the information given in this publication.