



HID-HighPower for SON/MH/HPL/HPI

BHL 2000 L76-A2 380/400/415V 50Hz HP-317

Encapsulated ballasts for use with SON (T) (Plus), HPL, HPI and MH lamps with rated wattages of 1000 W and above

Product data

| General Information | |
|---------------------|--------------|
| Number of Lamps | 1 piece/unit |

| Operating and Electrical | |
|--------------------------|--------------|
| Input Voltage | 380 to 415 V |
| Line Frequency | 50 Hz |
| Input Frequency | 50 Hz |

| Wiring | |
|----------------|-------|
| Connector Type | Screw |

| Approval and Application | |
|--------------------------|-----------------------------|
| Approval Marks | CE marking ENEC certificate |

| Product Data | |
|---------------------------------|--|
| Full product code | 871150006384700 |
| Order product name | BHL 2000 L76-A2 380/400/415V 50Hz HP-317 |
| Order code | 913700217903 |
| Numerator - Quantity Per Pack | 1 |
| Numerator - Packs per outer box | 1 |
| Material number (12NC) | 913700217903 |
| Full product name | BHL 2000 L76-A2 380/400/415V 50Hz HP-317 |
| EAN/UPC - Case | 8711500063847 |

HID-HighPower for SON/MH/HPL/HPI

Dimensional drawing

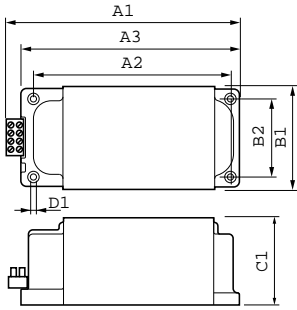

| Product | D1 | C1 | A1 | A2 | A3 | B1 | B2 |
|-------------------|-----|-------|-------|-------|-------|-------|------|
| BHL 2000 L76-A2 | 6.5 | 102.0 | 317.0 | 282.0 | 306.0 | 117.0 | 88.0 |
| 380/400/415V 50Hz | mm | mm | mm | mm | mm | mm | mm |
| HP-317 | | | | | | | |

