

LUPALO Scandia

612271.004.Z1 | Pole luminaires



Pole top luminaires
4051859679516
D 187, H 572

Pole mounting
silver, matt (approx. RAL 9006)

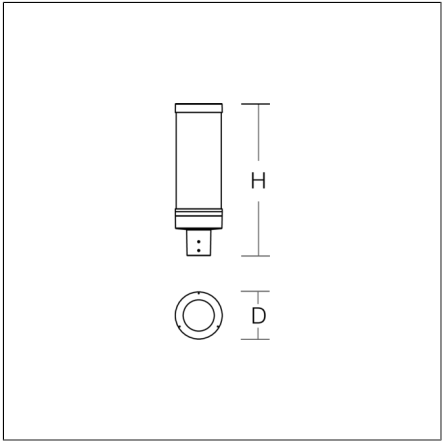

Pole-top luminaire with classic design and modern LED technology. Housing made of corrosion-resistant die-cast aluminium, seawater resistant powder-coated. With stainless steel screws. With membrane valve as a standard to avoid condensed water. Diffuser: glass, transparent. Multi-chip LED with high-performance refractor optics. Symmetrical light distribution Pole attachment for 76 mm spigot. With stainless steel screws. DALI-2 (D4i) control gear. 1 x Zhaga socket (Book 18) on top. With integrated movement sensor. Pre-assembled connection cable 2 x 0.75 mm², length 6 m. Please order reducer adapter for pole clamp D 60 mm separately. Order the top roof separately as an accessory for the classic lantern shape.

Product specifications

Diameter D	187 mm
Height H	572 mm
Weight	6.6 kg
Light source	LED
Colour temperature	3000 K
Rated luminous flux	1750 lm 4100 lm
System power	14 W 35 W
System efficiency	117 lm/W 125 lm/W
Glare evaluation UGR (4H 8H)	26 28,9
Beam angle	153°/153°
Rated life	100000 h (L80/B10)
Colour rendering index (CRI)	70
Colour tolerance	5
Photobiological safety according to EN 62471	Risk group 2
Driver	Converter, dimmable
Control	DALI Zhaga
Voltage	220 - 240 V / 50 - 60 Hz
Luminaires on B10A fuse	13
Luminaires on B16A fuse	21
Luminaires on C10A fuse	21
Luminaires on C16A fuse	35
Inrush current / Inrush current duration	21 A / 300 µs
CIE Flux Code / CEN Flux Code	15 45 92 100 100
Type of protection	IP 66
Protection class	II
Filament test	960°C - 30 seconds
Impact resistance	IK06
Ambient temperature	-20 °C ... + 40 °C
Conformity mark	CE

LUPALO Scandia

612271.004.Z1 | Pole luminaires



Accessories

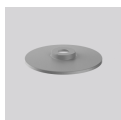

982752.004
Top roof



982762.000
Reducing adapter Ø 60 mm