



PrimaVision Twin for CDM

HID-PV C 2x35 /S CDM 220-240V 50/60Hz

Dual CDM lamp operation, single HID electronic gear – improves cost effectiveness and increases luminaire design flexibility

Product data

General Information		Mechanical and Housing	
Number of Lamps	2 piece/unit	Housing	/S
Operating and Electrical		Approval and Application	
Input Voltage	220 to 240 V	Approval Marks	F-Marking CE marking ENEC certificate CB Certificate
Line Frequency	50 to 60 Hz	Product Data	
Input Frequency	50 to 60 Hz	Full product code	872790089572800
Earth Leakage Current (Max)	0.5 mA	Order product name	HID-PV C 2x35 /S CDM 220-240V 50/60Hz
Inrush Current Width	0.5 ms	Order code	913700656866
Inrush Current Peak (Max)	33 A	Numerator - Quantity Per Pack	1
Number of Products on MCB (16A Type B) (Nom)	14	Numerator - Packs per outer box	12
Wiring		Material number (12NC)	913700656866
Connector Type	Insert	Full product name	HID-PV C 2x35 /S CDM 220-240V 50/60Hz
Temperature		EAN/UPC - Case	8727900895728
Ambient temperature range	-20 °C to 55 °C		
T-Case Lifetime (Nom)	70 °C		
T-Case Maximum (Max)	80 °C		

PrimaVision Twin for CDM

Dimensional drawing

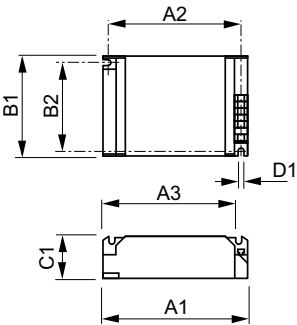

Product	D1	C1	A1	A2	B1	B2
HID-PV C 2x35 /S CDM 220-240V 50/60Hz	4.5 mm	32.0 mm	135.0 mm	123.5 mm	75.0 mm	63.5 mm

