

# Product Data Sheet

## GW46413

46 Range

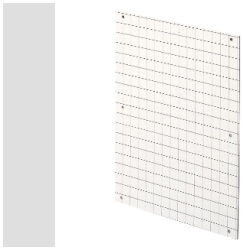

Accessories and complementary items for distribution and automation boards range 46.

|                     |            |              |                    |
|---------------------|------------|--------------|--------------------|
| For boards LxH (mm) | 585x800    | Suitable for | 46QP - 46QM - 46QX |
| Type of material    | Insulation | Electrocod   | 0303               |

### DIMENSIONAL

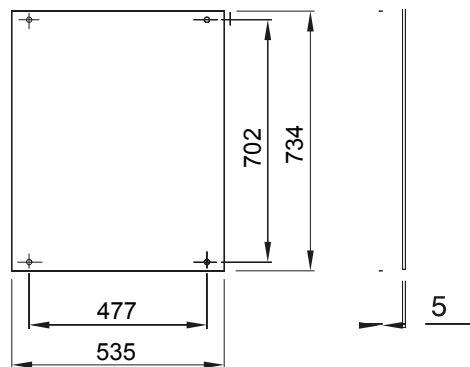

### STANDARDS/APPROVALS

