

# PRODUCT DATASHEET

## Decor Plate Pendant E27 Black Wood Decor

Decor Plate Pendant | Decorative luminaires made of metal with E27 socket



### Areas of application

- Indoor applications
- Corridors, entrance areas, stairwells, living rooms, basements

### Product benefits

- Slim design with decent color tones
- Lampshade design enables the lamp to be the luminaire highlight
- Minimalistic style fits to every room
- Sustainable solution thanks to exchangeable light sources
- Easy mounting

### Product features

- Housing material: metal
- Textile cable



## TECHNICAL DATA

### Electrical data

Nominal voltage	220...240 V
Mains frequency	50...60 Hz
Protection class	II
Operating mode	Mains voltage

### Dimensions & Weight

Diameter	400.00 mm
Height	1270.00 mm
Product weight	1700.00 g

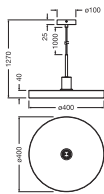

DECOR PLATE PENDANT E27 WD

### Materials & Colors

Product color	Black Wood decor
Housing color	Black Wood decor
Body material	Steel
Glow Wire Test according to IEC 60695-2-12	650 °C

### Application & Mounting

Ambient temperature range	-20...+40 °C
Temperature range at storage	-20...+80 °C
Type of connection	Terminal, 2-Pole (L, N)
Type of protection	IP20
Dimmable	No
Mounting type	Suspended
Application environment	Indoor
With light source	No

Holder designation	E27
--------------------	-----

### Certificates & Standards

Standards	CE / UKCA
Luminaire with limited surface temperature, "D sign"	No





### Additional product data

Product remark	Maximum bulb wattage: 25 W (LED 15 W)
Number of illuminants	1

### Safety advice

- All electrical connections must be made by a qualified person.
- Caution, risk of electric shock.
- Check wall-ceiling for suitability. If uncertain, seek professional advice.

### DOWNLOAD DATA

Documents and certificates	Document name
 User instruction / safety instructions	Decor Plate Plissee Pendant and Ceiling
 Legal information	DECOR PLATE/PLISSE/STRAW/LAYERS
 Declarations of conformity	DECOR LUM
 Declarations of conformity UKCA	DECOR LUM

### LOGISTICAL DATA

Product code	Packaging unit (Pieces/Unit)	Dimensions (length x width x height)	Gross weight	Volume
4058075838727	Folding box 1	112 mm x 492 mm x 498 mm	2116.00 g	27.44 dm <sup>3</sup>
4058075838734	Shipping box 4	510 mm x 475 mm x 520 mm	10030.00 g	125.97 dm <sup>3</sup>

The mentioned product code describes the smallest quantity unit which can be ordered. One shipping unit can contain one or more single products. When placing an order, for the quantity please enter single or multiples of a shipping unit.

### DISCLAIMER

Subject to change without notice. Errors and omission excepted. Always make sure to use the most recent release.