

# PRODUCT DATASHEET

## SP DRIVER DALI 8W

SP DRIVER | Professional DALI driver for LEDVANCE 8W SPOTs



---

### Areas of application

- DALI installations

---

### Product benefits

- DALI driver with individual luminaire current set-up already installed
- Extended services such as energy monitoring and remote maintenance possible with DALI versions
- Easy replacement of external driver thanks to plug with bayonet lock

---

### Product features

- IoT-ready driver with DALI-2 technology
- Push DIM function for dimming and switching directly on a pushbutton
- Suitable for emergency central battery installations acc. to EN 60598-2-22
- Twist & lock connector for ease of installation



## TECHNICAL DATA

### Electrical data

|   |             |
|---|-------------|
| Nominal wattage   | 8.00 W      |
| Nominal voltage   | 220...240 V |
| Mains frequency   | 50/60 Hz    |
| Max. number of luminaires per miniature circuit breaker B16 | 130         |
| Power factor $\lambda$                                      | 0.90        |
| Protection class  | II          |

### Dimensions & Weight

|                |           |
|----------------|-----------|
| Length         | 120.00 mm |
| Width          | 53.00 mm  |
| Height         | 30.00 mm  |
| Product weight | 100.00 g  |

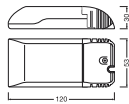

SP DRIVER DALI 8W

### Materials & Colors

|                 |                    |
|-----------------|--------------------|
| Product color   | Grey               |
| Body material   | Polycarbonate (PC) |
| Mercury content | 0.0 mg             |

### Application & Mounting

|                              |              |
|------------------------------|--------------|
| Ambient temperature range    | -20...+40 °C |
| Temperature range at storage | -42...+80 °C |
| Type of protection           | IP20         |
| Dimmable                     | Yes          |
| Type of dimming              | DALI2        |

### Control gear

|                |        |
|----------------|--------|
| Output current | 180 mA |
|----------------|--------|

## Emergency lighting

|   |        |
|---|--------|
| Wattage in emergency operation mode       | 3,0 W  |
| Luminous flux in emergency operation mode | 120 lm |

## Certificates & Standards

|           |                 |
|-----------|-----------------|
| Standards | CE / UKCA / EAC |
|-----------|-----------------|





## EQUIPMENT / ACCESSORIES

- Can only be used with LEDVANCE SPOTs 8 W (CC 180mA)

## Safety advice

- Do not cover with any thermal insulation material!

## DOWNLOAD DATA

| Documents and certificates   |  | Document name                      |
|--|--|------------------------------------|
|  | User instruction / safety instructions | UI SP FIX P and SP FIX ADJ         |
|  | User instruction / safety instructions | UI SP DK FIX P                     |
|  | User instruction / safety instructions | UI SP FP FIX P                     |
|  | Legal information                      | Informationstext 18 Abs 4 ElektroG |

| Tender texts   |                  | Document name        |
|--|------------------|----------------------|
|  | Tender documents | SP DRIVER DALI 8W-en |

## LOGISTICAL DATA

| Product code  | Packaging unit (Pieces/Unit) | Dimensions (length x width x height) | Gross weight | Volume               |
|---------------|------------------------------|--------------------------------------|--------------|----------------------|
| 4099854089558 | Folding box<br>1             | 35 mm x 220 mm x 62 mm               | 205.00 g     | 0.48 dm <sup>3</sup> |
| 4099854089565 | Shipping box<br>4            | 227 mm x 155 mm x 74 mm              | 1025.00 g    | 2.60 dm <sup>3</sup> |

The mentioned product code describes the smallest quantity unit which can be ordered. One shipping unit can contain one or more single products.

When placing an order, for the quantity please enter single or multiples of a shipping unit.

ADDITIONAL CATALOG INFORMATION

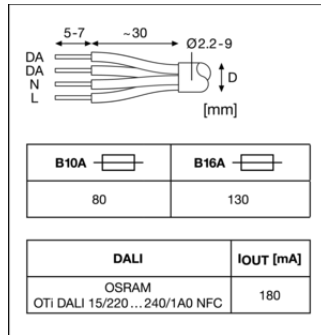
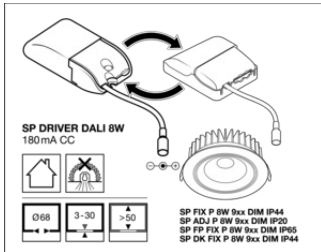

DISCLAIMER

Subject to change without notice. Errors and omission excepted. Always make sure to use the most recent release.