

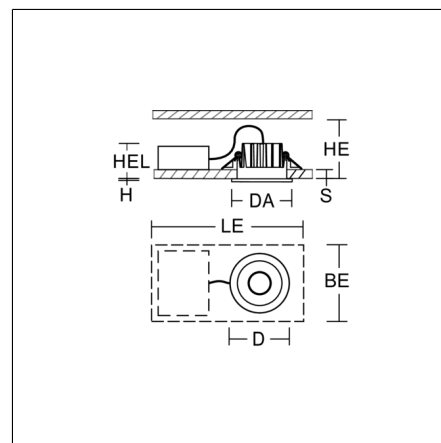

Recessed ceiling luminaires
4051859461951
D 62, H 3

Recessed ceiling mounting
white



Round emergency luminaire for escape route lighting. Housing: die-cast aluminium. Bezel ring: plastic. With plastic lenses for escape route illumination. Self-contained system with automatic self-test and feedback to the RZB monitoring system MULTIDIGIT. With enclosed separate ceiling mounting ring also suitable for ceiling cut-outs of Ø 68 mm.

Product specifications

Type of emergency lighting	Self-contained system
Monitoring	MultiDigit
Battery	NiMh
Duration	3 h
Operating mode	non-maintained power mode
Diameter D	62 mm
Height H	3 mm
Cut-out diameter DA	54-68 mm
Installation space height HE	76-162 mm
Luminaire: recess height HEL	42 mm
Ceiling thickness S	1-35 mm
Weight	420 g
Light source	LED
Colour temperature	6500 K
Rated luminous flux, mains operation	270 lm
System power, mains operation	5,2 W
Rated luminous flux, emergency operation	190 lm
System efficiency	52 lm/W
Glare evaluation UGR (4H 8H)	45,9
Beam angle	151°/99°
Colour rendering index (CRI)	70
Photobiological safety according to EN 62471	Risk group 1
Driver	Converter
Control	on/off
Voltage	220 - 240 V / 50 - 60 Hz
Inrush current / Inrush current duration	0.12 A / 5000 µs
CIE Flux Code / CEN Flux Code	35 68 98 100 100
Type of protection	IP 20
Protection class	II
Filament test	850°C - 30 seconds
Impact resistance	IK03
Ambient temperature for maintained power	0 °C ... + 35 °C
Ambient temperature for non-maintained power mode	0 °C ... + 35 °C
Safety marks	Do not cover the recessed luminaire!
Conformity mark	CE