

**UEBS 16 L400 B10.5 B6.5 AL CU (377 410)**

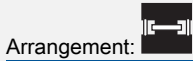

Figure without obligation

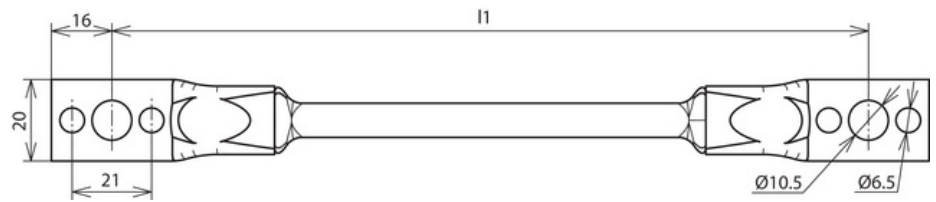

Type	UEBS 16 L400 B10.5 B6.5 AL CU
Part No.	377 410 ✓
Length (l1)	400 mm
Material of cable lug	Al
Material of cable	Cu
Cross-section	16 mm <sup>2</sup>
Fixing	[4x] Ø6.5 / [2x] Ø10.5 mm
Application note	according to DIN EN 62305-3 Supplement 1, materials ≥ 0.5mm thick shall be connected by 2 rivets Ø6mm, or materials ≥ 2mm thick by 2 tapping screws Ø6.3mm StSt (on both sides)
Insulation	rubber EM5 black
Temperature range	-40 °C ... +80 °C
Cable type	flexible
Lightning current carrying capability (10/350 µs)	50 kA *)
Standard	EN 62561-1
Weight	90 g
Customs tariff number	85389099
GTIN	4013364083035
PU	10 Stk

\*) For exact assignment, see test certificate.

We reserve the right to introduce changes in performance, configuration and technology, dimensions, weights and materials in the course of technical progress. The figures are shown without obligation.