

KombiSIGN 70 / Accessories

## Adapter for tube D25mm 1/2 Inch thread



**Part No.:** 975.840.02

### MECHANICAL DATA

Height	44 mm
Diameter	27 mm
Materials	Steel
Housing colour	Silver
Weight with packaging	88 g
Product weight	81 g

### APPROVAL DATA

Conforms with CE	No
Conforms with RoHS directive	Fulfills substance restriction
WEEE	No
Conforms with ATEX-directive	No
Conforms with CCC	No
Conforms with UL	No
Conforms with FCC	No
Conforms with IC	No
EAC certificate available	No
Conforms with AS-I	No
ICAO Certification	No
Conforms with DNV	No
Conforms with RoHS CN	No



For additional installation and mounting information, refer to the appropriate user guide at [www.werma.com](http://www.werma.com). This printed copy is for information only and is subject to alteration.

KombiSIGN 70 / Accessories

## Adapter for tube D25mm 1/2 Inch thread

### DRAWING

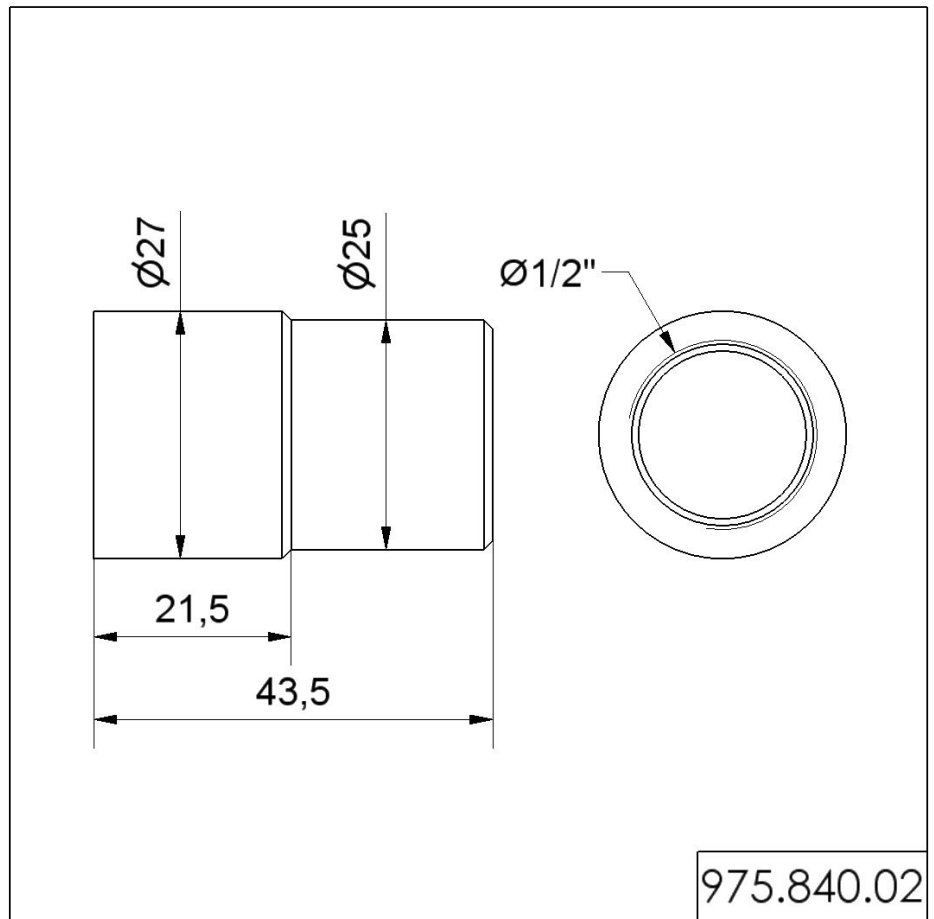

For additional installation and mounting information, refer to the appropriate user guide at [www.werma.com](http://www.werma.com). This printed copy is for information only and is subject to alteration.