

2 branches video splitter

Description

D45 System interface device used to splits the BUS signal into two channels where the video signal can only be transferred from input to output. It provides compensation to the two channels separately and adapts the video signal output from the entrance panel for different distances by video gain settings DIP SWITCH. Mainly used in riser system to divide the riser BUS into several channels. Example : one building particularly high, will use 323007 to adjust video gains by splitting in two channels. One channel is used for lower floors, the other for higher floors. Device can also be used for physically connect the porter switchboard and extend the switchboard installation (in this case, if the switchboard is fitted with a camera, the video signal cannot be transmitted to the handset).

DIN RAIL installation.

Technical data

Power supply: 30 Vdc
 Stand by current absorption: ≤ 25 mA @ 30 V
 Max operating current absorption: ≤ 70 mA @ 30 V
 Stand by power consumption: 0.75 W
 Operating power consumption: 2.1 W
 Operating temperature: (-10)-(+40)°C

Dimensional data

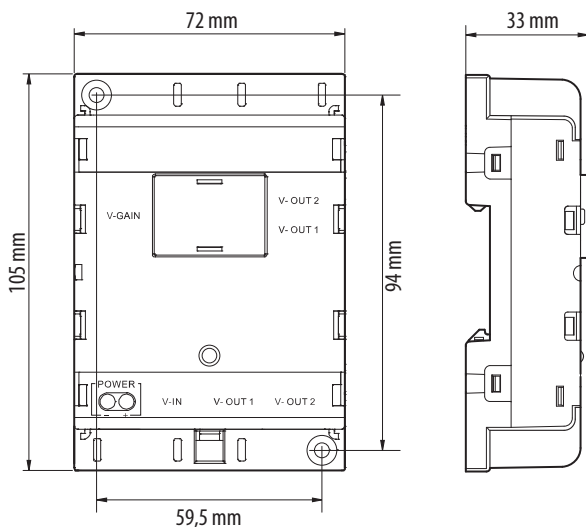

Front view

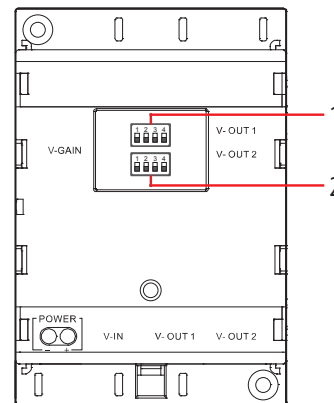

Lower view

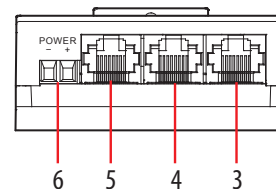

Legend

1. Branch 1 video gain setting DIP SWITCH
2. Branch 2 video gain setting DIP SWITCH
3. Branch 2 RJ45 System BUS output connector
4. Branch 1 RJ45 System BUS output connector
5. RJ45 System BUS input connector
6. Auxiliary power supply input connector (30 V)

Video gain setting



DIP switch setting instruction



	Distance	1	2	3	4
Colour signal	0 – 300 m	OFF	OFF	OFF	OFF
	300 – 700 m	ON	OFF	OFF	OFF
	700 – 1000 m	ON	ON	OFF	OFF
B/W signal	1000 – 1500 m	ON	ON	ON	OFF
	1500 – 2000 m	ON	ON	ON	ON