

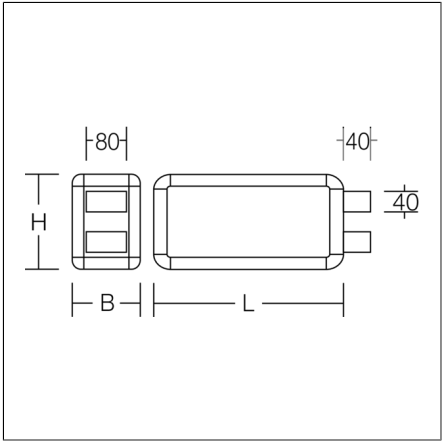

Extensions  
4051859950196  
L 362, B 125, H 192

Wall (surface)  
anodised aluminium



Rectangular wall extension luminaire in classic design. For escape route identification. Housing: aluminium, with plastic corner connectors. Display panels: plastic, opal, with motifs on one side/on both sides. Wall extension Driver integrated. Suitable for connection to central battery systems. With AC Control monitoring module for LUXIFAIR central battery units. Please indicate legend number when placing your order!

Product specifications

Type of emergency lighting	Central battery system
Monitoring	Luxifair AC-Control
Battery	without
Operating mode	maintained power mode
Viewing Distance	32 m
Length L	362 mm
Width B	125 mm
Height H	192 mm
Projection AL	40 mm
Weight	2.08 kg
Light source	LED
Colour temperature	4000 K
System power, mains operation	5,2 W
System power, emergency operation	5,2 W
Photobiological safety according to EN 62471	Risk group 1
Driver	Converter
Control	on/off
Voltage	220 - 240 V / 0 Hz, 50 Hz
Luminaires on B10A fuse	17
Luminaires on B16A fuse	27
Luminaires on C10A fuse	28
Luminaires on C16A fuse	45
Inrush current / Inrush current duration	27 A / 250 µs
CIE Flux Code / CEN Flux Code	29 57 81 65 100
Type of protection	IP 44
Protection class	I
Filament test	650 °C
Impact resistance	IK03
Ambient temperature for maintained power	-10 °C ... + 40 °C
Ambient temperature for non-maintained power mode	-10 °C ... + 40 °C
Conformity mark	CE, EAC