

# PRODUCT DATASHEET

## SMART+ ZB OUTDOOR PLUG EU

SMART+ OUTDOOR PLUG | Outdoor Plug with smart socket to control non smart devices with ZigBee technology



---

### Areas of application

- Wherever non-smart devices need to be integrated into compatible smart home systems
- Gardens, balconies and other outdoor areas

---

### Product benefits

- Integrates conventional electric equipment into compatible smart home systems
- Enables switching of conventional light sources and other electric devices
- Simple connection of electric devices via standard socket
- The socket cover can be closed for the protection against splash water

---

### Product features

- Control via compatible smart home system or on/off button on the device
- Control via voice control available: Google Assistant or Amazon Alexa, depending on the smart home system in use
- 1.5 m power cable for flexible installation
- High switching power: up to 3,680 W / 16 A
- Network protocol: ZigBee 3.0
- Type of protection: IP44



– For full functionality, connection to a compatible smart home System (gateway and app) required

---

## TECHNICAL DATA

### Electrical data

Nominal voltage	230 V
Mains frequency	50 Hz

### Dimensions & Weight

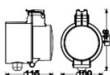

Product weight	610.00 g
Diameter	100 mm
Length	146 mm
Width	100 mm
Height	115 mm

### Lifespan

Number of switching cycles	100000
----------------------------	--------

### Colors & materials

Product color	White
Body material	Plastic

### Temperatures & operating conditions

Ambient temperature range	-20...+35 °C
---------------------------	--------------

### Capabilities

Compatible smart home technology	Amazon Alexa / Google Assistant / Philips Hue
----------------------------------	---

### Certificates & Standards

Protection class	I
Type of protection	IP44

---



## EQUIPMENT / ACCESSORIES

- Control via app requires a compatible Smart home system

### Safety advice

- Disconnect devices which generate heat from the mains, i.e. from the SMART+ Plug, after use in order to avoid them being accidentally switched on.
- Very high capacitive and inductive loads may in some cases lead to destruction of the device or reduction in the number of switching cycles.
- Do not use the SMART+ Plug in conjunction with medical equipment.
- To be connected to an automatic circuit breaker (max. 16 A).
- Product in protection class I. All electrically conductive, metallic housing parts that can absorb voltage during operation or during maintenance in the event of a fault must be continuously connected to the protective earthing conductor.

### DOWNLOAD DATA

Documents and certificates		Document name
	Extended installation guide	SMART ZIGBEE INSTALLATION GUIDE
	Declarations of conformity	SMART ZB OUTDOOR PLUG EU

### LOGISTICAL DATA

Product code	Packaging unit (Pieces/Unit)	Dimensions (length x width x height)	Gross weight	Volume
4058075729308	Folding box 1	208 mm x 146 mm x 115 mm	730.00 g	3.49 dm <sup>3</sup>
4058075729315	Shipping box 8	608 mm x 223 mm x 260 mm	6530.00 g	35.25 dm <sup>3</sup>

The mentioned product code describes the smallest quantity unit which can be ordered. One shipping unit can contain one or more single products. When placing an order, for the quantity please enter single or multiples of a shipping unit.

### DISCLAIMER

Subject to change without notice. Errors and omission excepted. Always make sure to use the most recent release.