

61802180	<b>DATA SHEET</b>	
Valid from: 03.07.2018	<b>SILVYN® US-AS</b>	

SILVYN® US-AS is an inner- / end sleeve for the installing form protection conduits on the gland SILVYN® US or as an end sleeve to prevent cable from being damaged, when there is no gland installation.



**Material:** Nickel plated brass

**Temperature range:** -40°C up to +250°C

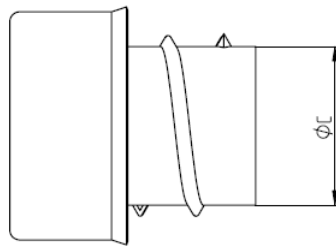

**Dimension table:**

Part No.	Part name	Nominal size	Conduit diameter mm		Diameter C mm
			Inner	Outer	
6180 2180	SILVYN® US-AS 7	10	8,0	10,0	6,5
6180 2190	SILVYN® US-AS 9	14	11,0	14,0	10,0
6180 2200	SILVYN® US-AS 11	17	14,0	17,0	12,5
6180 2210	SILVYN® US-AS 13,5	19	16,0	19,0	14,5
6180 2220	SILVYN® US-AS 16	21	18,0	21,0	16,5
6180 2230	SILVYN® US-AS 21	27	23,0	27,0	21,5
6180 2240	SILVYN® US-AS 29	36	31,0	36,0	29,5
6180 2250	SILVYN® US-AS 36	45	40,0	45,0	38,0
6180 2270	SILVYN® US-AS 48	56	51,0	56,0	49,0
<b>For SILVYN® LAPPGRAFF</b>					
61802191	SILVYN US-AS 9 Agraff	14	12	14	10,5
61802231	SILVYN US-AS 21 Agraff	27	24	27	22,5

**Suitable conduits:** SILVYN® AS

**Suitable gland:** SILVYN® US  
SILVYN® US-M

For more information please see our current catalogue. Please do not hesitate to contact our laboratory if there are any questions regarding resistance against aggressive agents and special oil.

Creator: M. Wegerer /PDP Released: DAMU1/PDP	Document: DB61802180EN Version: 04	Page 1 of 1
---	---------------------------------------	-------------